

For LEASE | Komohana Industrial Park

91-029  
MALAKOLE STREET  
KAPOLEI, HAWAII 96707

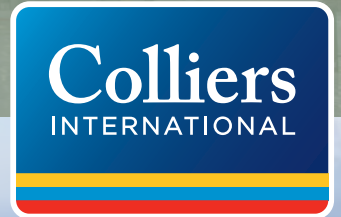



# For LEASE | Komohana Industrial Park



## THE BUILDING

Opportunity to lease 44,763 square feet of warehouse space with 28' to 32' ceiling height. Space includes 2,612 square feet of newly renovated offices with a partial kitchen, restrooms with shower, three container loading docks with levelers, new lighting, concrete floors, sprinklers, and 46,183 square feet of paved and secure yard area at no charge.

Area:	James Campbell Industrial Park Kapolei, Hawaii
TMK:	(1) 9-1-32-110 (portion of)
Zoning:	I-2 Intensive Industrial
Size:	44,763 SF
Asking Rent:	\$1.20 psf per month
Operating Expenses:	\$0.16 psf per month
Available:	January 1, 2018
Features & Benefits:	<ul style="list-style-type: none"><li>• Clean and secured; ready to occupy</li><li>• 3-phase 400 amp electrical service</li><li>• Easy access from Malakole Street</li><li>• Located in a heavy industrial area</li><li>• Near Kalaeloa Barbers Point Harbor</li></ul>

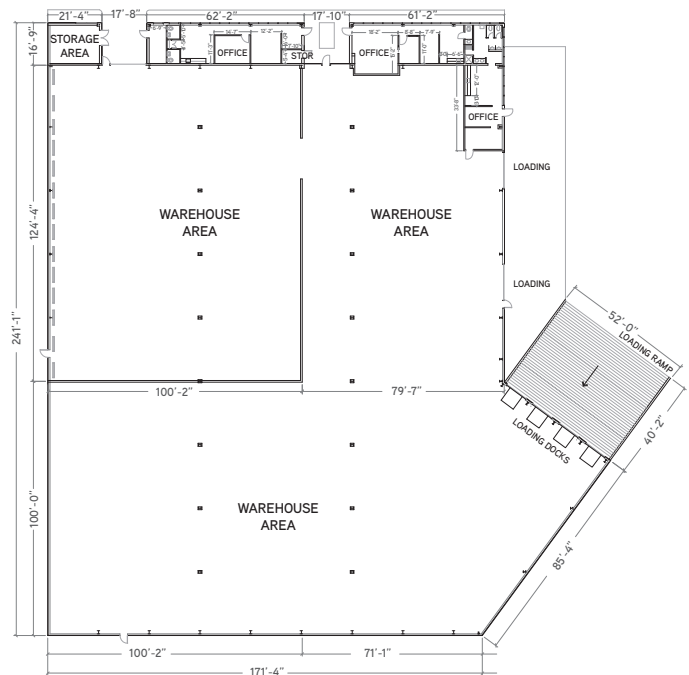

## Contact Us

RONALD C. WARD (S)  
Industrial Services Division  
808 523 9747  
[ronald.ward@colliers.com](mailto:ronald.ward@colliers.com)

WILLIAM "BILL" FROELICH (S), CCIM, SIOR  
Industrial Services Division  
808 523 9711  
[william.froelich@colliers.com](mailto:william.froelich@colliers.com)

ALIKA COSNER (S)  
Industrial Services Division  
808 523 8339  
[alika.cosner@colliers.com](mailto:alika.cosner@colliers.com)

91-029  
MALAKOLE STREET  
KAPOLEI, HAWAII 96707





# For LEASE | Komohana Industrial Park

91-029  
MALAKOLE STREET  
KAPOLEI, HAWAII 96707



COLLIERS INTERNATIONAL  
220 South King Street, Suite 1800  
Honolulu, HI 96813

[www.colliers.com/hawaii](http://www.colliers.com/hawaii)

## Contact Us

RONALD C. WARD (S)  
Industrial Services Division  
808 523 9747  
[ronald.ward@colliers.com](mailto:ronald.ward@colliers.com)

WILLIAM "BILL" FROELICH (S), CCIM, SIOR  
Industrial Services Division  
808 523 9711  
[william.froelich@colliers.com](mailto:william.froelich@colliers.com)

ALIKA COSNER (S)  
Industrial Services Division  
808 523 8339  
[alika.cosner@colliers.com](mailto:alika.cosner@colliers.com)

This document has been prepared by Colliers International for advertising and general information only. Colliers International makes no guarantees, representations or warranties of any kind, expressed or implied, regarding the information including, but not limited to, warranties of content, accuracy and reliability. Any interested party should undertake their own inquiries as to the accuracy of the information. Colliers International excludes unequivocally all inferred or implied terms, conditions and warranties arising out of this document and excludes all liability for loss and damages arising there from. This publication is the copyrighted property of Colliers International and/or its licensor(s). ©2017. All rights reserved.

## LOCATION | Kapolei Hawaii

Komohana Industrial Park is a 35-acre industrial park located in James Campbell Industrial Park. The Park provides easy access from Malakole and Komohana Streets to barge services in Kalaeloa Barbers Point Harbor. It is just minutes away from the City of Kapolei with access to all freeways and highways.

